

*開關產品未經SWITRONIC同意，請勿拆解，否則無法負品質及安全責任。
 Please do not decompose the switch without any permission from SWITRONIC,
 otherwise the quality and safety responsibility could not be guaranteed.

*本圖面若與目錄之規格尺寸不符，以本圖面規格尺寸為主。
 Below is our main specification if different from catalog.

RoHS compliant

P.C.B. LAYOUT

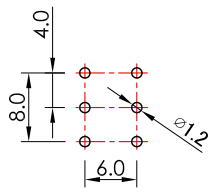

SCHEMATIC

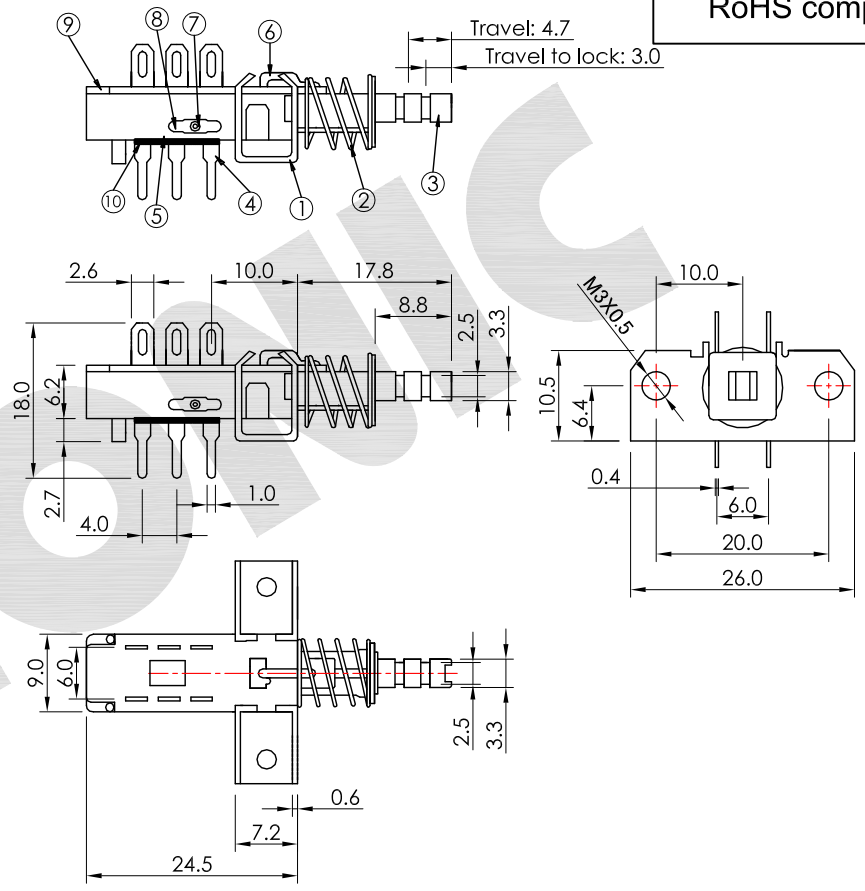
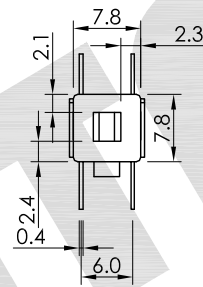
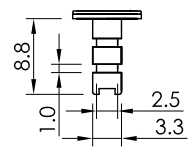
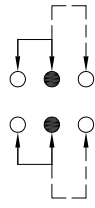

SPECIFICATION

Rating: 0.5A 100V AC / 0.2A 250V AC,
 1A Max. 25V DC.

Timing: Non-Shorting.

Contact resistance: 30mΩ Max.(initial)

Insulation resistance: 100MΩ Min. at 500V DC.

Withstand voltage: 500V AC for 1 minute.

Operating temperature: -20 ~ 70°C.

Operating force: 300±100g.

Life: 10,000 Cycles.

Soldering temperature: 250°C Max. for 3 sec.

Soldering time: 1 time only.

Note 1: Unwashable, don't be immersed by epoxy and organic solvent.

Note 2: Please check actual size, do not scale the drawing page.

MATERIAL

- Bracket:** SPCC, Zi plated. ———— ①
- Spring $\phi 0.5$:** SUS, natural. ———— ②
- Slider:** POM, white. ———— ③
- Terminal:** Brass strip, Ag plated. ———— ④
- Slider:** POM, blue. ———— ⑤
- Hook:** SUS, natural. ———— ⑥
- Spring $\phi 0.18$:** SUS, natural. ———— ⑦
- Contact clip:** Brass strip, Ag plated. ———— ⑧
- Base:** Phenolic resin, natural. ———— ⑨
- Epoxy:** Epoxy, yellow. ———— ⑩

產品 PRODUCT	Pushbutton Switch		型號 MODEL NO.	P10-1EABM1L-G
製圖 DRAWN BY	核圖 CHECKED BY	主管 APPROVED BY	單位 UNIT	mm
Peter Kuo	Chuck Young	Margaret Lee	比例 SCALE	1 : 1
			公差 TOLERANCE	.X=±0.3mm, .XX=±0.2mm

SWITRONIC
 INDUSTRIAL CORP.
Switches



一綺電子企業股份有限公司
 總公司：110 台北市信義路四段415號13樓之3
 13F-3 NO. 415, SEC. 4, Hsin Yi Road, Taipei, Taiwan
 TEL : 886-2-27290229 (Rep.) FAX : 886-2-27582086
 URL : http://www.switronic.com.tw
 E-MAIL : switches@ms36.hinet.net